

GUNZE

# For Trauma-Orthopedic Surgery

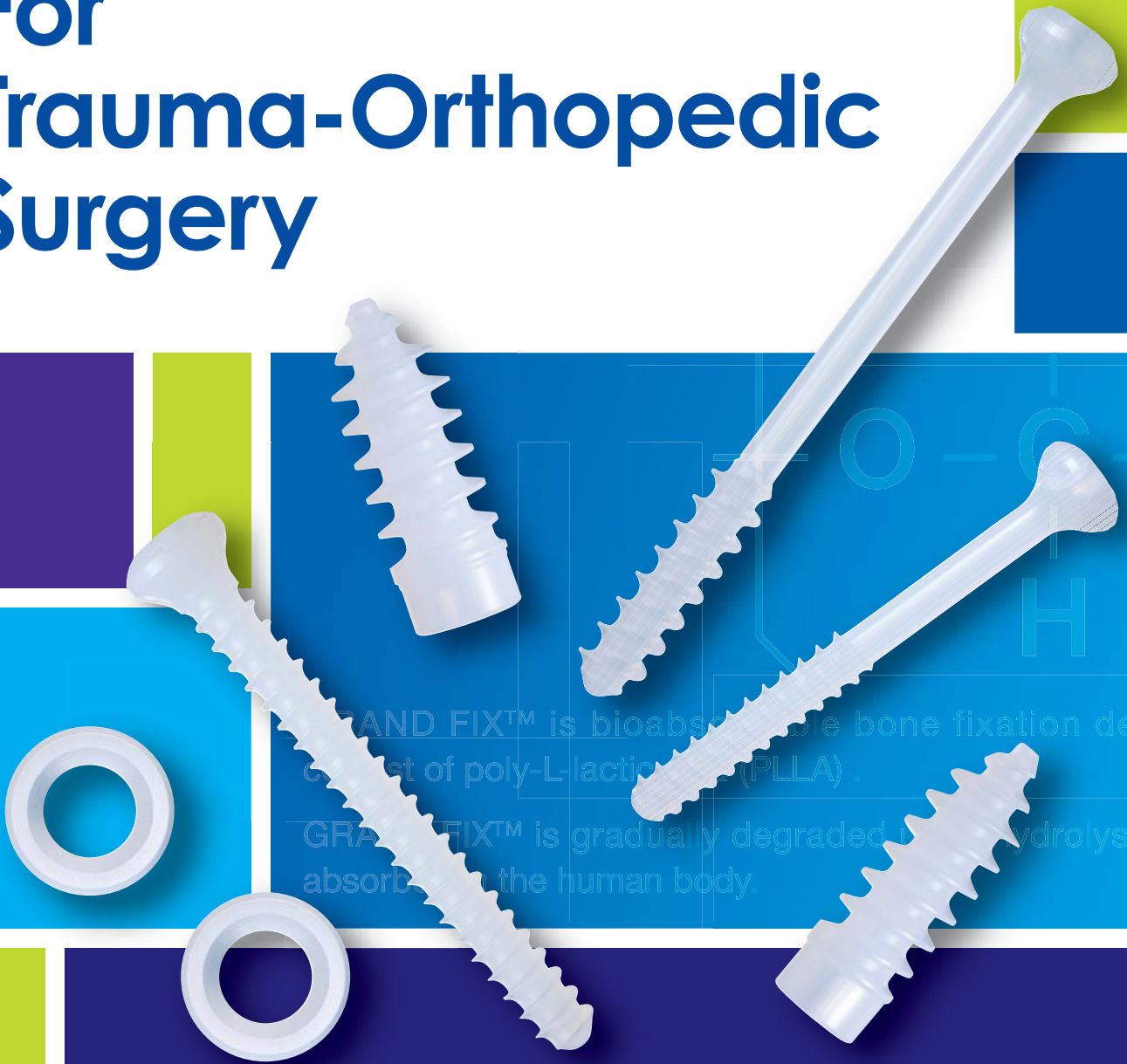

GRAND FIX™ is bioabsorbable bone fixation devices  
consist of poly-L-lactide (PLLA).

GRAND FIX™ is gradually degraded by hydrolysis and  
absorbed in the human body.

# GRAND FIX™

Bioabsorbable Bone Fixation Devices

# Characteristics

GRAND FIX™ is bioabsorbable bone fixation devices consist of poly-L-lactic acid (PLLA) .

GRAND FIX™ is gradually degraded upon hydrolysis and absorbed in the human body.

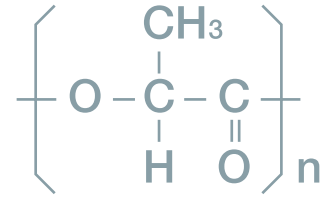

## Bioabsorbability

### Bioabsorbability

Bending Strength Retention

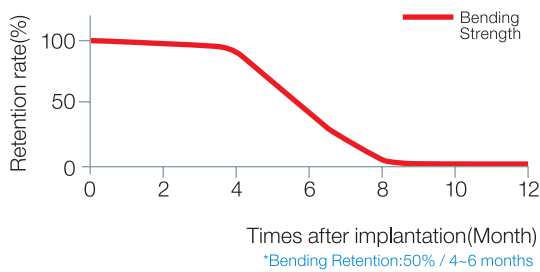

### Strength

Bending Strength

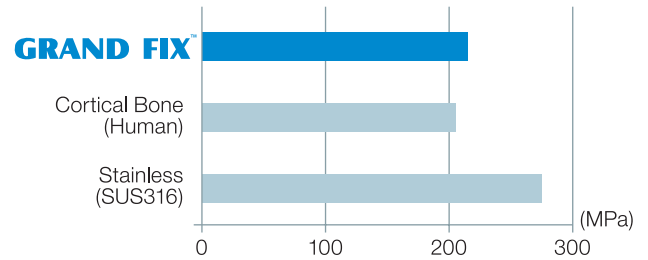

## Product Variation

### PIN

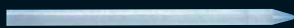

### Operational procedures and methods of Pins

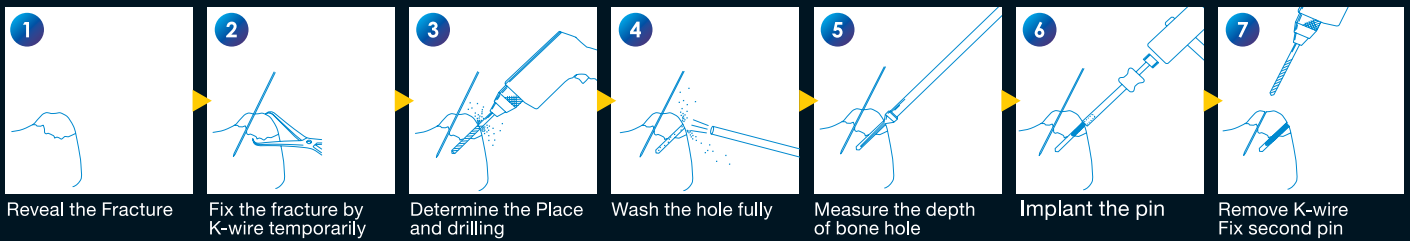

### Exclusive Instruments for Pin

Pin Pusher



Drill (1.5mm~4.5mm)



Depth Gauge

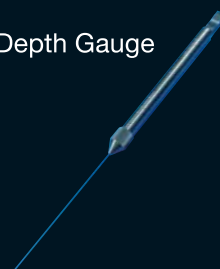

## Instruction

### 1 Osteosynthesis

• Fixation of finger and toe fracture (shaft of small bone fracture)

### 2 Osteotomy

• Fixation of bone fragment in Rotational Acetabular Osteotomy

### 3 Bone transplantation

• Fixation of transplanted bone in artificial joint replacement  
 • Fixation of transplanted bone to the defect after tumor excision

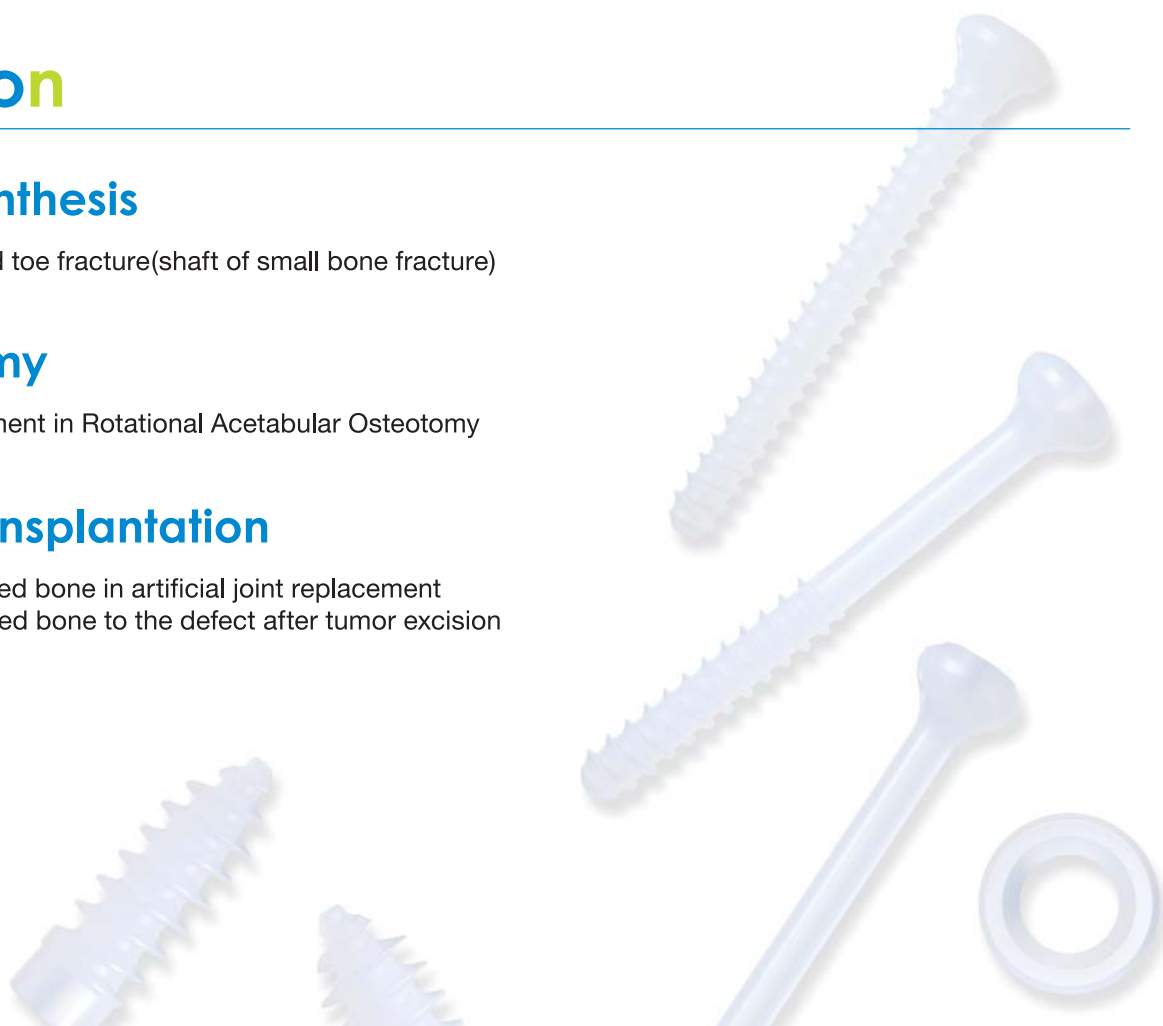

## Screw



Malleolar Screw  
(for malleolar bone)

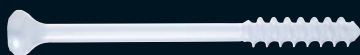

Cancellous Screw  
(for cancellous bone)



Cortical Screw  
(Full thread screw)



Washer

## Operational procedures and methods of Screws

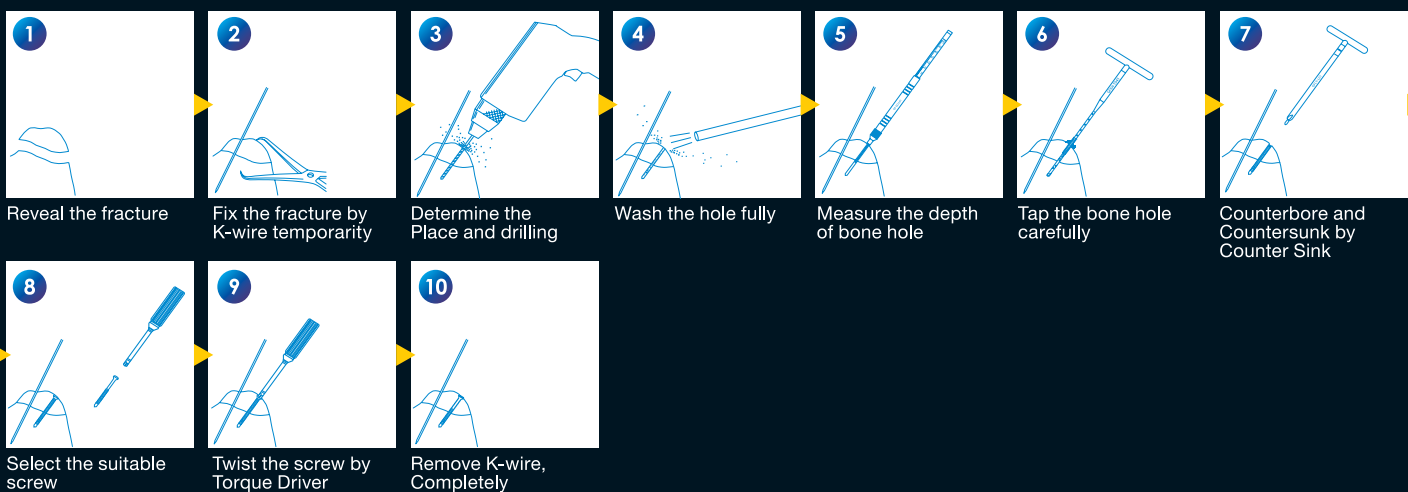

## Exclusive Instruments for Screws

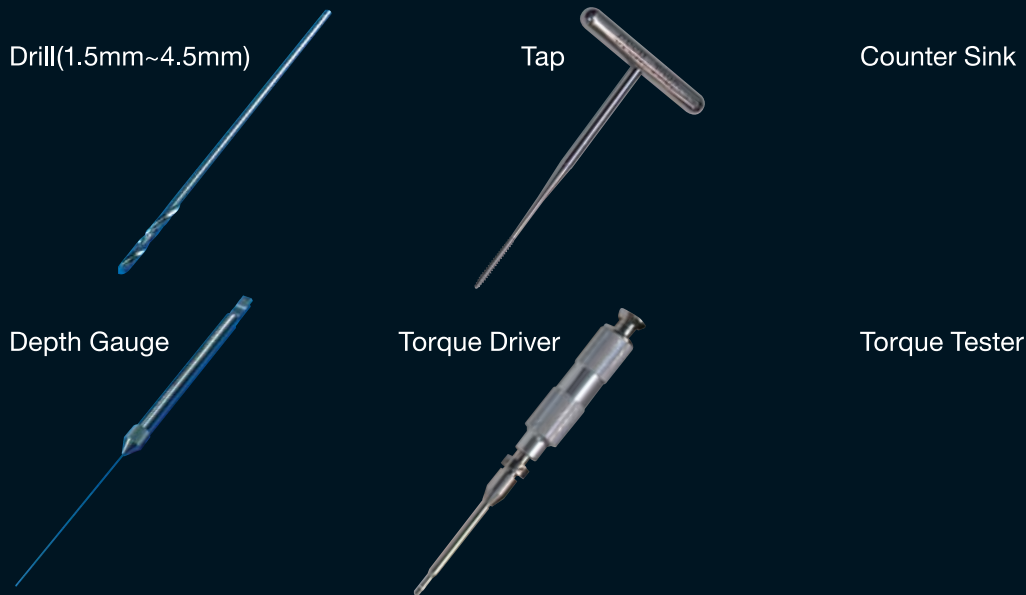

## ACL Screw



Pro No.	Diameter	Total Length
ACL-80025	8.0mm	25mm
ACL-90025	9.0mm	25mm



PLLA Interference screw for joint surgery Exclusive Instruments as driver and tap are available

## Contact

2-10-4 Nihonbashi, Chuo-ku, TOKYO 1030027 Japan  
 GUNZE LIMITED Medical Division  
 PHONE 81-3-3276-8718 FAX 81-3-3276-8696  
[www.gunze.co.jp/e/medical/index.html](http://www.gunze.co.jp/e/medical/index.html)

# GUNZE

All rights of whole information including the sentence, pictures, chart, etc in this brochure are retained by GUNZE Medical Division. Unauthorized use, disclosure, or copying of those information or any part thereof is strictly prohibited may be unlawful.